

Please read instructions carefully before installation. We recommend this product be installed by a qualified, and experienced technician. If you are unsure of any of the below directions and or your ability to correctly and securely install this product, please contact us or your local dealer for help.

Below diagrams show typical installation, your vehicle may be different so please use diagrams as a guide. Make sure your vehicle is clean and free from dirt, road grime etc. where the this product mounts. It is the riders responsibility to make sure the product is mounted and secure before each use. Loading the bag may result in a change of position, always check for proper mounting position after loading and before each and every ride.

**For use on Polaris models\* '14-'19 RZR XP 1000 & Turbo, RZR XP4 1000 & Turbo, RZR 900, RZR 4 900**

**STOP:** If you are also installing the optional lower bags RG-001L, install the lower bags first per instructions

If you have the Stock door only or Polaris Part number 2879510 optional full door skin installed.

1. Open bag and remove the optional knee pad for installation. This can be replaced when completed.
2. Hold bag up to door and align the bags grommets with stock holes on RZR door frame.
3. Insert the supplied plastic push trees into the 6 holes.

If you have the Polaris part number 2879509 Optional lower doors installed.

1. Remove the factory screws to the optional lower doors at the location of the lower 2 grommets on the bag.
2. Open bag and remove the optional knee pad for installation. This can be replaced when completed.
3. Hold bag up and align holes in the bag with stock holes on your RZR door frame.
4. Re-insert the lower door screws through the bag grommets and into door frame.
5. Insert the supplied plastic push trees into the upper 3 holes. Note: 1 hole on the RG-002 is located inside the pocket.

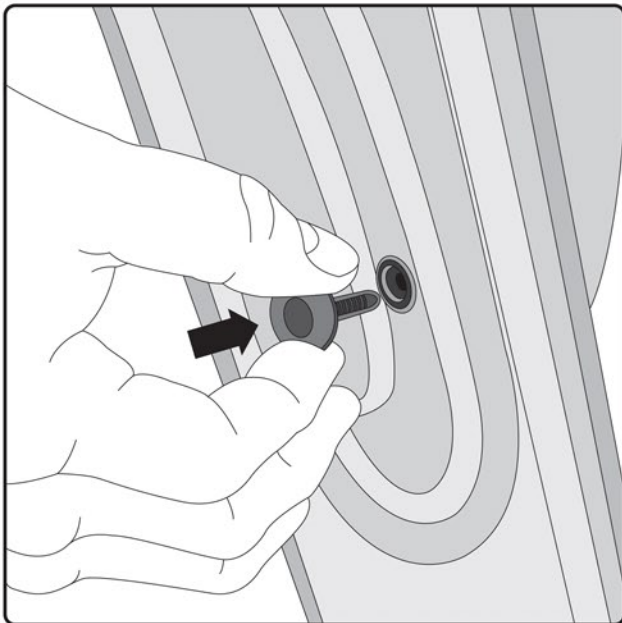
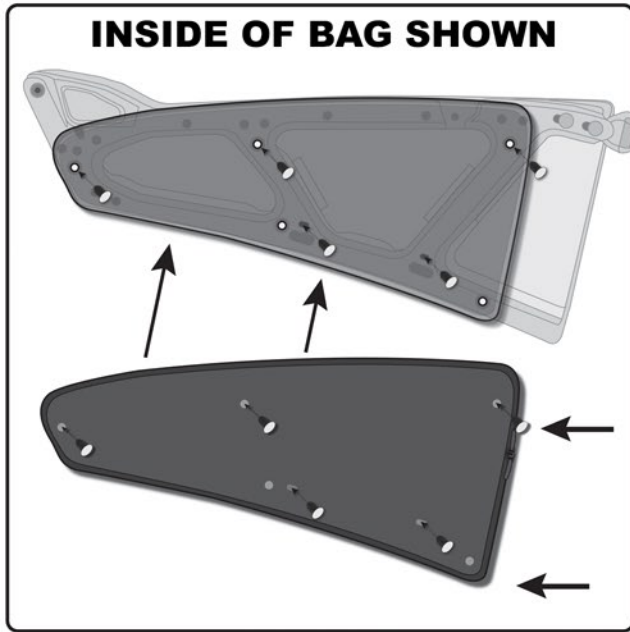

**Warning:**  
 Read the installation instructions and make yourself familiar with the process of installing the Nelson-Rigg® product(s) on your bike. It is your responsibility to mount the product correctly and securely as outlined in these instructions. Nelson-Rigg® products are intended for use at USA street legal speeds as posted by the individual States. Nelson-Rigg® luggage must not be overloaded. Max carrying capacity is 10 lbs per bag or the maximum load suggested by the manufacturer of the vehicle, whichever is less.  
 Failure to adhere to these warnings may result in, but not be limited to: the luggage becoming detached, the product becoming tangled in moving parts of the vehicle, unstable vehicle dynamics, reduction in the ability to control the vehicle. The result(s) could lead to serious injury.  
**Always ride safely, adhering to the local highway regulations. Always wear a helmet and protective apparel.**

3518-A Lake Center Dr Santa Ana, CA 92704  
 Tel (714)850-1811 Fax (714)850-1848  
 e-mail: [info@nelsonrigg.com](mailto:info@nelsonrigg.com) [www.nelsonrigg.com](http://www.nelsonrigg.com)

